

LX130

HITACHI

LX130

W H E E L L O A D E R

- Engine Rated Power : 129 kW (175 PS)
- Operating Weight : 13 770 kg
- Bucket Capacity : ISO Heaped
2.1 m³ – 3.2 m³

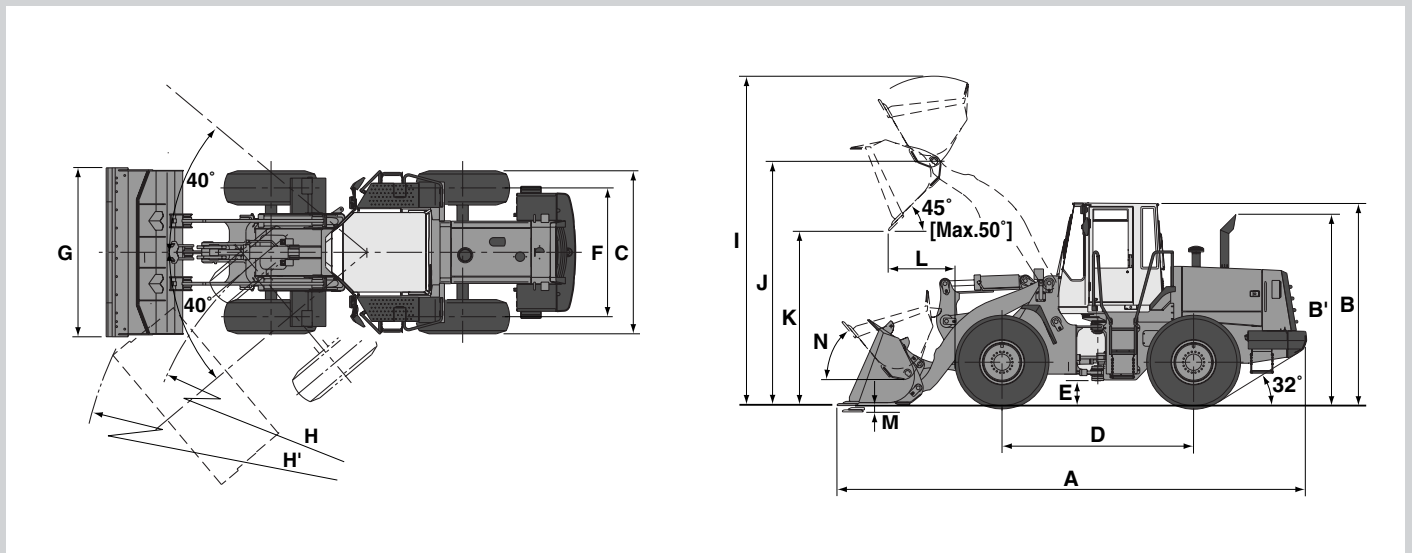

Unit : mm

	LX130-7
A Overall length	7 520
B Height to top of cab	3 240
B' Height to top of exhaust	3 040
C Width over tires	2 610
D Wheel base	3 050
E Ground clearance	405
F Tread	2 050
G Bucket width	2 690
H Turning radius (Centerline of outside tire)	5 230
H' Loader clearance circle, bucket in carry position	6 100
I Overall operating height	5 250
J Height to bucket hinge pin, fully raised	3 890
K Dumping clearance 45 degree, full height	2 770
L Reach, 45 degree dump, full height	1 060
Reach, 45 degree dump, 7 ft (2.13 m) clearance	1 555
M Digging depth (Horizontal digging angle)	100
N Max. roll back at carry position	50 deg.
Tire size	20.5 - 25 - 12PR (L3)

Note: General purpose bucket with bolt on cutting edges.



ENGINE

Model Isuzu BB-6HK1T
 Type 4-cycle water-cooled, direct injection
 Aspiration Turbocharger
 No. of cylinders 6
 Rated power
 DIN 6 272, net 129 kW (175 PS) at 2 300 min⁻¹ (2 300 rpm)
 SAE J1349, net 129 kW (173 HP) at 2 300 min⁻¹ (2 300 rpm)
 Bore and stroke 115 mm x 125 mm
 Piston displacement 7.790 L
 Electrical system 24 V with 0.96 kW, 50 A alternator
 Starting system 24 V x 5.0 kW electric motor
 Batteries 2 x 12 V / 916 CCA, 270-min. rated reserve
 Air cleaner Two element dry type with restriction indicator



POWER TRAIN

Transmission Torque converter, countershaft type powershift with computer-controlled automatic shift and manual shift features included.
 Torque converter Three element, single stage, single phase
 Main clutch Wet hydraulic, multi-disc type
 Cooling method Forced circulation type
 Travel speed* : km/h

	Forward	Reverse
1st	7.5 /	8.0
2nd	12.0 /	13.5
3rd	22.0 /	24.0
4th	34.5 /	37.0

**With 20.5-25-12PR (L3) tires*



AXLE AND FINAL DRIVE

Drive system Four-wheel drive system
 Front & rear axle Semi-floating
 Front : Fixed to the front frame
 Rear : Trunnion support
 Reduction and differential gear Two stage reduction with torque proportional differential
 Oscillation angle ±12° ; total 24°
 Final drives Heavy-duty planetary, mounted inboard



TIRES (tubeless, nylon body)

Standard 20.5-25-12PR (L3)
 Optional Refer to standard & optional equipment list



BRAKES

Service brakes Inboard mounted fully hydraulic 4 wheel wet disc brake.
 Front & rear independent brake circuit
 Parking brake Wet multiple disc mechanical type built in transmission



STEERING SYSTEM

Type Articulated frame steering
 Steering mechanism Full hydraulic power steering with orbital
 Steering angle Each direction 40° ; total 80°
 Relief pressure 18.6 MPa (190 kgf/cm²)
 Cylinders Two double-acting piston type
 No. x Bore x Stroke 2 x 80 mm x 422 mm
 Minimum turning radius at
 the centerline of outside tire 5.23 m



HYDRAULIC SYSTEM

Arm and bucket are controlled by independent control lever
 Arm controls Four position valve ; Raise, hold, lower, float
 Bucket controls with automatic bucket
 return-to-dig control Three position valve ; Roll back, hold, dump
 Main pump Gear type 100 L/min
 @2 300 min⁻¹ (rpm) at 17 160 KPa (175 kgf/cm²)
 Steering pump Gear type 141 L/min
 @2 300 min⁻¹ (rpm) at 20 590 KPa (210 kgf/cm²)
 Brake and assist pump Gear type 29 L/min
 @2 300 min⁻¹ (rpm) at 4 410 KPa (45 kgf/cm²)
 Charging pump Double gear type with two discharge ports
 Front pump Front 86 L/min
 @2 300 min⁻¹ (rpm) at 2 450 KPa (25 kgf/cm²)
 Rear pump Rear 40 L/min
 @2 300 min⁻¹ (rpm) at 490 KPa (5 kgf/cm²)
 Relief pressure setting 20 590 KPa (210 kgf/cm²)
 Hydraulic cylinders
 Type Two arm and one bucket, double acting type
 No. x Bore x Stroke Arm : 2 x 140 mm x 760 mm
 Bucket : 1 x 170 mm x 495 mm
 Filters Full-flow 15 micron return filter in reservoir
 Hydraulic cycle times
 Lift arm raise 5.8 s
 lower 3.3 s
 Bucket dump 1.4 s
 Total 10.5 s



SERVICE REFILL CAPACITIES

Fuel tank 230 L
 Engine coolant 47.5 L
 Engine oil 19 L
 Torque convertor & transmission 25 L
 Front axle differential & wheel hubs 28 L
 Rear axle differential & wheel hubs 28 L
 Hydraulic reservoir 80 L



DIMENSIONS & SPECIFICATIONS

Arm type			Standard arm					
			General purpose			Rock bucket		Light material handling
			With bolt-on cutting edges	With bolt-on teeth	With bolt-on teeth & segments	With bolt-on teeth	With bolt-on teeth & segments	With bolt-on cutting edges
Bucket capacity	ISO heaped	m ³	2.7	2.6	2.7	2.2	2.2	3.2
	ISO struck	m ³	2.3	2.2	2.3	1.9	1.9	2.8
Bucket width		mm	2 690	2 690	2 690	2 690	2 690	2 690
Working range								
Dumping clearance 45 degree, full height		mm	2 770	2 670	2 670	2 745	2 745	2 665
Reach, 45 degree dump, full height		mm	1 060	1 130	1 130	1 065	1 065	1 175
Reach, 45 degree dump, 7 ft (2.13 m) clearance		mm	1 555	1 580	1 580	1 550	1 550	1 615
Reach with arm horizontal and bucket level		mm	2 465	2 600	2 600	2 500	2 500	2 625
Digging depth (Horizontal digging angle)		mm	100	110	110	110	110	100
Overall operating height		mm	5 250	5 250	5 250	5 200	5 200	5 350
Overall length (Bucket on ground)		mm	7 520	7 660	7 660	7 560	7 560	7 675
Loader clearance circle, bucket in carry position		mm	6 100	6 140	6 140	6 110	6 110	6 140
Static tipping load *	Straight	kgf	11 000	10 800	10 700	10 450	10 350	10 600
	Full 40 degree turn	kgf	9 500	9 300	9 200	9 000	8 850	9 100
Breakout force		kN (kgf)	125 (12 700)	136 (13 900)	129 (13 200)	149 (15 200)	141 (14 400)	110 (11 200)
Operating weight *		kgf	13 700	13 640	13 760	14 120	14 240	13 790

Arm type			High-lift arm		Standard arm with quick coupler			
			General purpose		General purpose		Light material handling	
			With bolt-on cutting edges	With bolt-on teeth	With bolt-on cutting edges	With bolt-on teeth	With bolt-on cutting edges	
Bucket capacity	ISO heaped	m ³	2.3	2.1	2.3	2.1	2.7	
	ISO struck	m ³	2.0	1.8	2.0	1.8	2.4	
Bucket width		mm	2 690	2 690	2 690	2 690	2 690	
Working range								
Dumping clearance 45 degree, full height		mm	3 295	3 190	2 720	2 620	2 665	
Reach, 45 degree dump, full height		mm	1 035	1 105	1 120	1 190	1 175	
Reach, 45 degree dump, 7 ft (2.13 m) clearance		mm	1 915	1 940	1 590	1 600	1 615	
Reach with arm horizontal and bucket level		mm	2 685	2 820	2 545	2 680	2 625	
Digging depth (Horizontal digging angle)		mm	160	170	100	110	100	
Overall operating height		mm	5 580	5 580	5 300	5 300	5 480	
Overall length (Bucket on ground)		mm	7 820	7 970	7 595	7 740	7 675	
Loader clearance circle, bucket in carry position		mm	6 240	6 290	6 150	6 200	6 180	
Static tipping load *	Straight	kgf	10 100	10 200	9 800	9 850	9 700	
	Full 40 degree turn	kgf	8 750	8 800	8 400	8 450	8 300	
Breakout force		kN (kgf)	130 (13 300)	144 (14 700)	121 (12 300)	130 (13 300)	114 (11 600)	
Operating weight *		kgf	14 170	14 100	14 240	14 170	14 310	

Notes: 1. All dimensions, weight and performance data based on ISO 6746-1:1987, ISO 7131:1997 and ISO 7546:1983

2. Static tipping load and operating weight marked with * include 20.5-25-12PR (L3) tires (No ballast) with lubricants, coolant, full fuel tank and operator. Machine stability and operating weight depend on counterweight, tire size and other attachments.

Tires and Options	Change in operating weight		Change in tipping load	
	kg	Straight	Full turn	
		kg	kg	
20.5-25-12PR (L2) Bias ply	- 52	- 50	- 40	
20.5-25-16PR (L2) Bias ply	- 20	- 20	- 10	
20.5-25-16PR (L3) Bias ply	36	30	30	
20.5-25-16PR (L4) Bias ply	—	—	—	
20.5-25-12PR (L5) Bias ply	—	—	—	
20.5-25-16PR (L5) Bias ply	552	430	380	
20.5 R25 (L3 type) Radial ply	364	280	250	
20.5 R25 (L5 type) Radial ply	—	—	—	
FRP roof canopy (In lieu of ROPS/FOPS cab)	—	—	—	
ROPS/FOPS canopy (In lieu of ROPS/FOPS cab)	—	—	—	
Lumber and pallet fork (Pin on type)	—	—	—	
Log grapple (Pin on type)*	1 620	1 160	1 023	
Lumber grapple (Pin on type)	—	—	—	
Counterweight, CW*A	565	1 390	1 230	
Counterweight, CW*B	450	940	830	

Note: * With counterweight CW*A, counterweight CW*B and 20.5-25-16PR (L3) tires



BUCKET SELECTION GUIDE

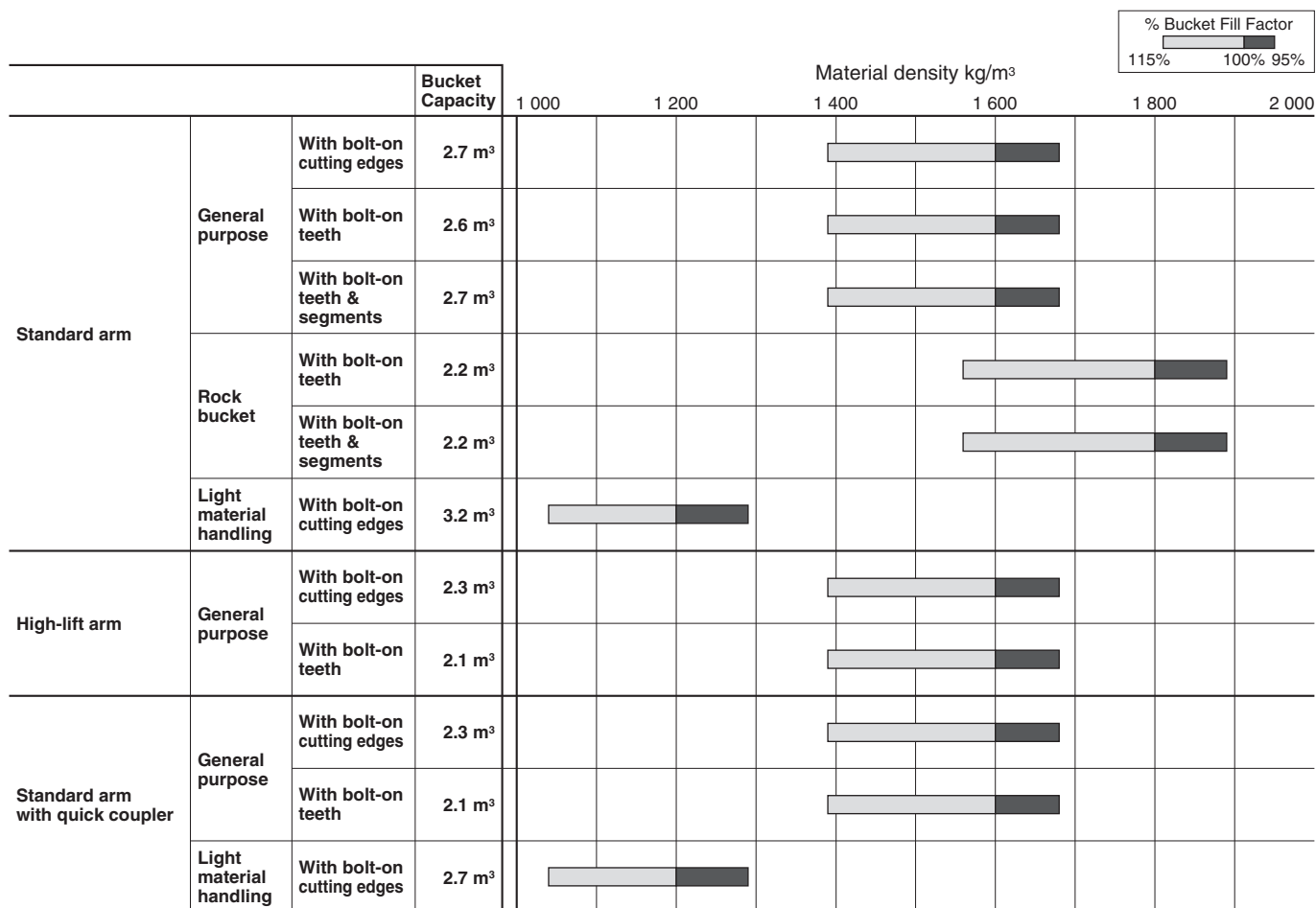

STANDARD & OPTIONAL EQUIPMENT

ENGINE		Operator warning lights: Engine oil pressure / Engine air filter / Alternator voltage (Charge)	●	General purpose bucket with bolt on teeth and segments : 2.7 m ³ (ISO heaped)	□
Coolant recovery tank	●	Indicator lights: Turn signals / Warning flashers / High beam of driving light / Work lights / Park brake / Engine preheat / Clutch cut off / Gear shift	●	Rock bucket with bolt on teeth: 2.2 m ³ (ISO heaped)	□
Fan guard	●	Indicator lights: Emergency steering (If Emergency steering is equipped)	□	Rock bucket with bolt on teeth and segments: 2.3 m ³ (ISO heaped)	□
Muffler, under hood with large exhaust stack	●	24-volt AM/FM stereo radio with clock	●	Light material handling bucket with bolt on cutting edges : 3.2 m ³ (ISO heaped)	□
Environmentally friendly engine oil drain	●	24-volt AM/FM stereo radio with cassette player and clock	□	Quick coupler and hydraulic control system for quick coupler locking pins, includes all controls in the cab, lines, and valves	□
Engine oil cooler	●	Radio-ready cab, fused 24-volt radio electrical lead, speaker (2), and antenna*	□	Full line of Hitachi buckets for quick coupler with selection of bolt-on cutting edges, and bolt-on teeth*	□
Quick-release fuel filter and water separator	●			General purpose bucket with bolt on cutting edges : 2.3 m ³ (ISO heaped)	□
Glow system (For cold start)	●	OPERATOR'S STATION		General purpose bucket with bolt on teeth: 2.1 m ³ (ISO heaped)	□
Air filter double element	●	Canopy*	●	Light material handling bucket with bolt on cutting edges : 2.7 m ³ (ISO heaped)	□
Air pre-cleaner	□	FRP roof / Multiplane isolation mount for noise/vibration reduction	□	Full line of construction utility forks, pallet forks, and attachments*	□
Wide fin radiator	●	Cab		Lumber and pallet fork : Max load 4 600 kg (Pin on type)	□
Fuel double filter	□	ROPS** / FOPS*** / Multi-plane isolation mounted for noise/vibration reduction / Front and rear windshield washers / Safety grass	●	Log grapple : Max load 6 100 kg (Pin on type)	□
		Sun visor	●	Lumber grapple : Max load 6 100 kg (Pin on type)	□
POWER TRAIN		Heater / Defroster (Cab model only)	□		
TC/PS transmission, computer-controlled automatic shift and manual shift features included	●	Less Heater & Defroster (Cab model only)*	□	TIRES	
DSS (Down Shift Switch) and USS (Up Shift Switch)	●	Air conditioning (Factory or dealer installed)	□	Bias ply :	
Torque proportioning differentials, front and rear	●	Seat belt, 50 mm	●	20.5-25-12 PR (L2)	□
Auto transmission 3 mode selection switch	●	Seat belt, 76 mm, with retractor*	□	20.5-25-16 PR (L2)	□
		Seat, close covered , high back, mechanical suspension, adjustable for weight-height, fore-aft position, backrest tilt, and armrest angle	□	20.5-25-12 PR (L3)	●
HYDRAULIC SYSTEM		Seat, fabric covered, high back, air suspension, adjustable for weight-height, fore-aft position, backrest tilt, and armrest angle*	□	20.5-25-16 PR (L4)	□
Automatic bucket return-to-dig control	●	Seat backrest extension	□	20.5-25-16 PR (L5)	□
Automatic arm height kickout control	●	Lunch box tray	□	20.5-25-12 PR (L5)	□
Automatic arm return-to-carry control* (GSS: Ground Stop System)	□	Rubber floor mat	●	20.5-25-16 PR (L5)	□
Reservoir sight gauge	●	Tilt steering	●	Radial ply :	
Hydraulic filters, vertical mounting	●	Steering wheel, textured with spinner knob	●	20.5R25 (L3 type)	□
Two-function hydraulic valve with joystick control (Pilot controlled)*	□	Rear view mirrors, outside (2) and inside (2)	●	20.5R25 (L5 type)	□
Two-function hydraulic valve with two levers	●	Handholds and steps, ergonomically located and slip resistant	●	Multi-piece rims	●
Adjustable wristrest	□	Cool box (Air-conditioner is necessary)	□	OTHERS	
Three-function hydraulic valve with two levers control and auxiliary lever for third function	□	Rear defroster (Cab model only)	□	Fenders, front and rear	●
Four-function hydraulic valve with two levers control and auxiliary joystick for third and fourth function	□	LOADER LINKAGE		Articulation locking bar	●
Ride control, automatic type	□	Z-bar loader linkage provides (High bucket breakout)	●	Anti-vandal protection, includes lockable engine enclosure, and fuel fill	●
		High-lift arm*	□	Counterweight, built-in	●
ELECTRICAL		BUCKETS AND ATTACHMENTS		Counterweight, extra duty*	□
24-volt electrical system	●	Full line of Hitachi pin on buckets with selection of bolt-on cutting edges, and teeth-segmented bolt on edges*	●	Drawbar, with rocking pin	●
Standard batteries (2), 12 volt with 916 CCA, 270-min. rated reserve	●	General purpose bucket with bolt on cutting edges : 2.7 m ³ (ISO heaped)	●	Bottom guards, front frame and transmission	□
High-capacity batteries (2), 12 volt with 1045 CCA, 304-min. rated reserve	□	General purpose bucket with bolt on teeth: 2.6 m ³ (ISO heaped)	□	Bottom guards, engine*	□
Alternator, 50 amps and 24 volts	●			Lift and tie-down hooks	●
Alternator, high capacity, 90 amps and 24 volts	●			Fire extinguisher (Dealer installed)	□
Lights	●			Emergency steering*	□
Driving with guards / Turn signals and flashers / Stop, tail and back-up lights	●			Open type rear grill*	□
Work lights on cab, front (2)	●			Tropical pack* (For the hot weather condition)	□
Work lights, rear (2)	●				
Horn, with push button in center of steering wheel	●				
Reverse warning alarm	●				
Monitor and alarm system, multi-function electronic	●				
Audible and visual warning include	●				
Analog instruments: Engine coolant temperature / Transmission oil temperature / Fuel level / Speedometer	●				
Digital instrument: Hour-meter	●				

Note: ● Standard equipment □ Optional or special equipment

* : Please consult your Hitachi dealer for further information

** : ROPS (Roll Over Protective Structure) Conforms to ISO 3471;1994

*** : FOPS (Falling Objects Protective Structure) Conforms to ISO 3449; 1992 Level II

 **Hitachi Construction Machinery Co., Ltd.**

Head Office: 5-1 Koraku 2-chome, Bunkyo-ku,
Tokyo 112-8563, Japan

Telephone: (03)3830-8050

Facsimile: (03)3830-8204

*These specifications are subject to change without notice.
Illustrations and photos show the standard models, and may or may not include optional
equipment, accessories, and all standard equipment with some differences in color and features.
Before use, go through Operators Manual for proper operation.*

KL-E121

03.09 (KA/KA, MT₃)

Printed in Japan